

Installation Guide UBX-710T Chin up & Dips

Side View

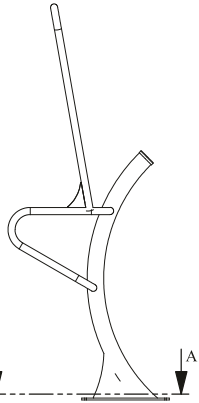

Top View

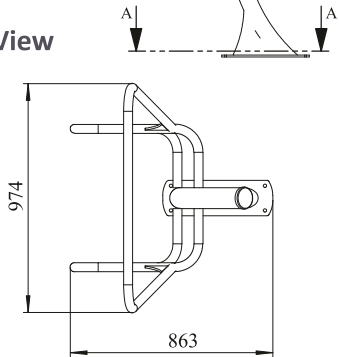

Front View

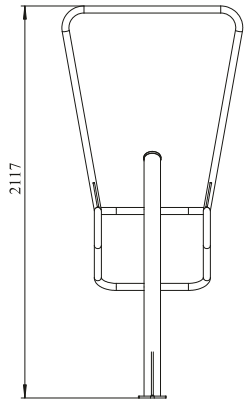

Surface installation
with anchor bolt

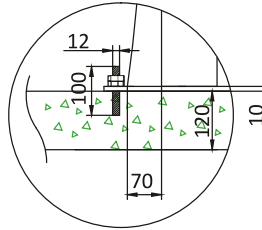

Inground footer
installation

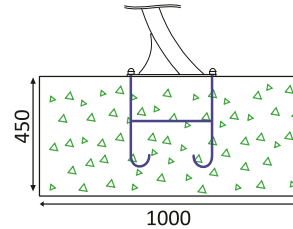

Block Installation:

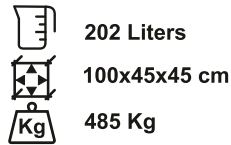

Base Plate Dimension

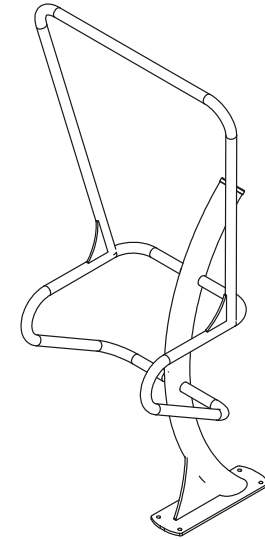
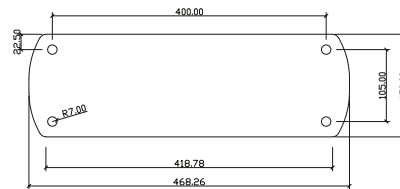

Standard Safety Area

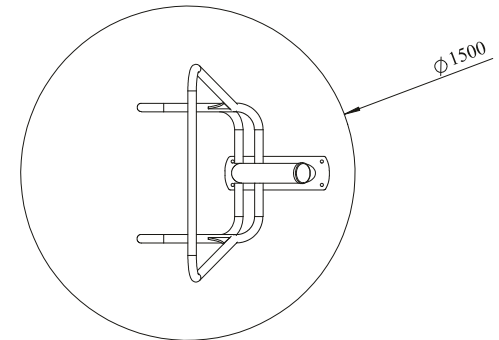

Installation instruction:

1. All units must be fully assembled and leveled before curing.
2. Body assembly screws must be attached using LocTite243.
3. Prevent access until concrete completely dry.
- *4. Footer is ordered separately