

- maximum free fall height: 60 cm
- no fall-protective ground surface required



ASSEMBLY DRAWING

Bearbeiter: Hector Roca

Datum: 22.08.2014

Page: 1/2

Spiel-Bau GmbH
Alte Weinberge 21 - D-14776 Brandenburg / Havel
Tel.: 03381 / 26 14 0 - Fax.: 03381 / 26 14 18

Rinne L=150cm
Order-No.: 3.3100.a-E-E-en

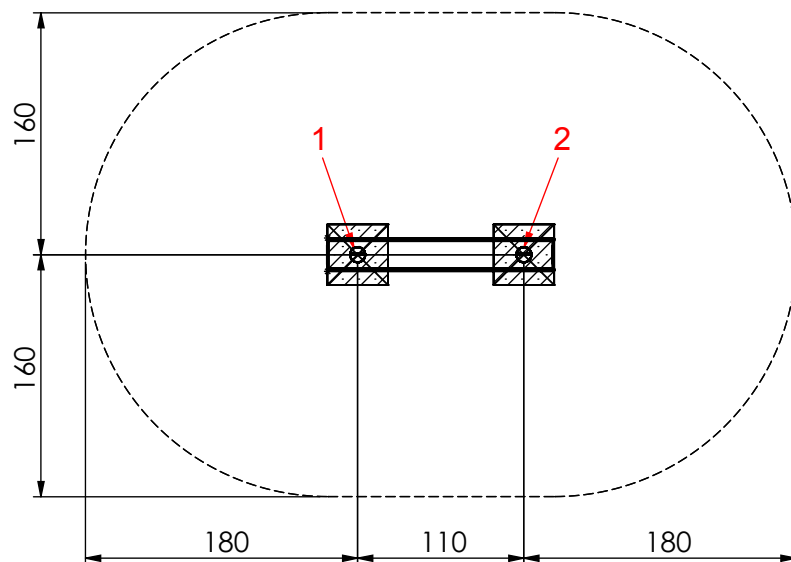

Foundation: In-situ concrete C25/30

- Posts 1 to 2:
each 40x40x40 cm look at detail a-E)

Foundation detail - post a-E)
Scale 1:25

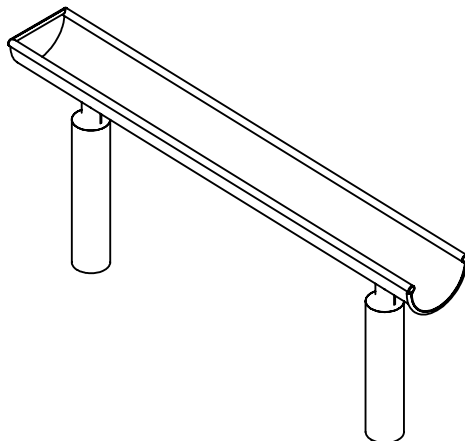
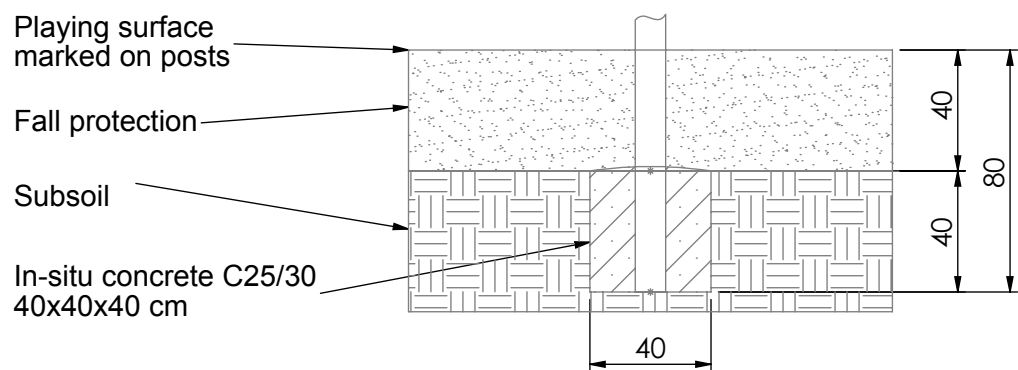

ASSEMBLY DRAWING

Bearbeiter: Hector Roca

Datum: 22.08.2014

Page: 2/2

Spiel-Bau GmbH
Alte Weinberge 21 - D-14776 Brandenburg / Havel
Tel.: 03381 / 26 14 0 - Fax.: 03381 / 26 14 18

Rinne L=150cm

Order-No.: 3.3100.a-E-E-en